

ULTRA THIN BLOCK SECTION: ONLY 1/8" THICKER THAN TUBE OD!

02

INTEGRATED BUSES PROVIDE THE LOWEST COST ASSEMBLIES AND REQUIRE LESS OVERALL SPACE AND PROVIDE THE LIGHTEST FINISHED WEIGHT!

INTEGRATED BUS
KK-02-INT-S-xxxx-*t-*m

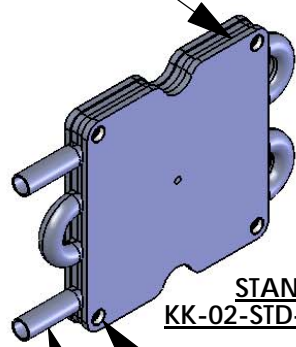

STANDARD
KK-02-STD-xxxx-*t-*m

THRU THREAD (4 PLACES ALL MODELS) FOR OPTIONAL CUSTOMER MOUNTING OR ATTACHMENT

FOUR PASS FLUID PATH TUBE ALLOWS IMPROVED AND MORE EVEN HEAT TRANSFER WITH SMALLER PIPING REQUIREMENTS. NO WELDS OR SOLDERED CONNECTIONS.

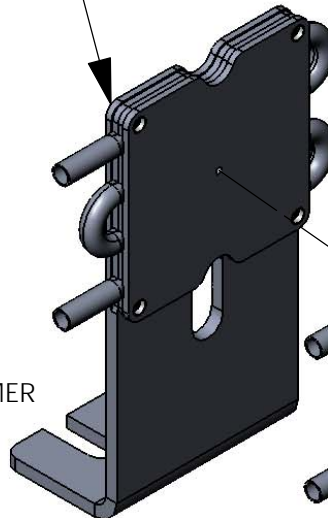

INTEGRATED BUS
KK-02-INT-L-xxxx-*t-*m

SPECIALLY DESIGNED TO ACCEPT A WIDE RANGE OF PRECISION MOUNTING CLAMPS

CUSTOM BUS LENGTHS, SHAPES AND CONNECTION PATTERNS AVAILABLE

FLUSH MOUNTING BOTH SIDES ALLOWS OVERSIZED POLE FACES

USE OUR STANDARD BUS TABS OR CONNECT TO YOUR OWN

INTEGRATED BUS
KK-02-INT-S-xxxx-*t-*m

STOCK THE UNIVERSAL WATER BLOCK AND ASSEMBLE RIGHT, LEFT OR STRAIGHT CONFIGURATIONS AS NEEDED. (SUPPLIED WITH BUS FASTENER HARDWARE).

UNIVERSAL BUS
KK-UNI-BUS-xxxx-S-*m (STRAIGHT)

CUSTOM MOUNTING HOLES AND SLOTS AVAILABLE

UNIVERSAL BUS
KK-02-UNI-L-xxxx-*t-*m

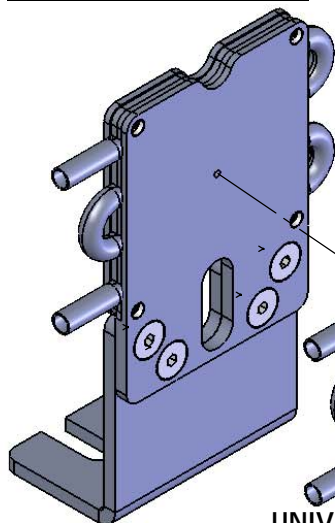

UNIVERSAL BUS
KK-02-UNI-S-xxxx-*t-*m

(UNIVERSALLY ASSEMBLED BUSES ARE AVAILABLE FULLY ASSEMBLED AS SHOWN)

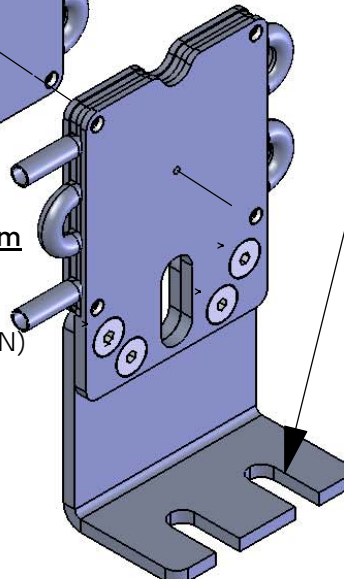

UNIVERSAL BUS
KK-02-UNI-R-xxxx-*t-*m

UNIVERSAL BUS
KK-02-UNI-xxxx-*t-*m

UNIVERSAL BUS
KK-UNI-BUS-xxxx-R-*m (RIGHT) (SHOWN)
KK-UNI-BUS-xxxx-L-*m (LEFT) (NOT SHOWN)